



**P502/348 St Kilda Road MELBOURNE VIC**

1 1

Favourably positioned on one of Melbourne's most iconic tree-lined boulevards.

This amazing \*50sqm domain located on the top floor showcases a spacious and free flowing living/dining room, including smart design bedroom with built in robes, large bathroom, modern kitchen, euro laundry, ducted reverse cycle air-conditioning and private balcony/terrace with breathtaking views.

The secure apartment is a blank canvass, with scope to add your style and flair.

World class amenities at the highly regarded "Seasons Botanic Gardens?", featuring heated indoor pool, spa, sauna, gym, restaurant and bar.

This lifestyle address is in an enviable location, close to Royal Botanic Gardens, Domain Road Village, Art Centre Melbourne, public transport options and Southbank Precinct.

**Price** : \$ 312,500  
**Land Size** : 50 sqm  
**View** : <https://www.petermarkovic.com.au/sale/vic/nner-city/melbourne/residential/apartment/7420410>



**Antonio Lorusso**  
**0477220003**

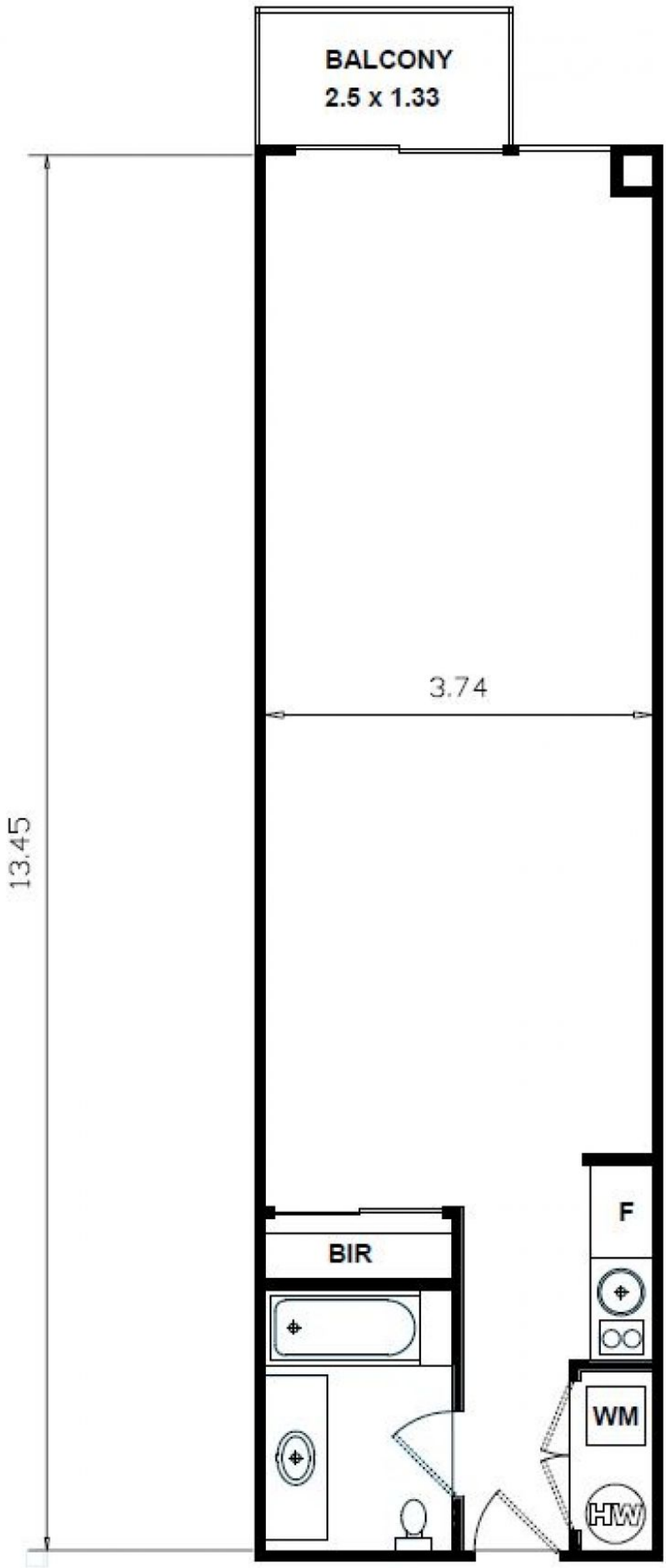

BALCONY  
2.5 x 1.33

13.45

3.74

BIR

F

WM

HW